

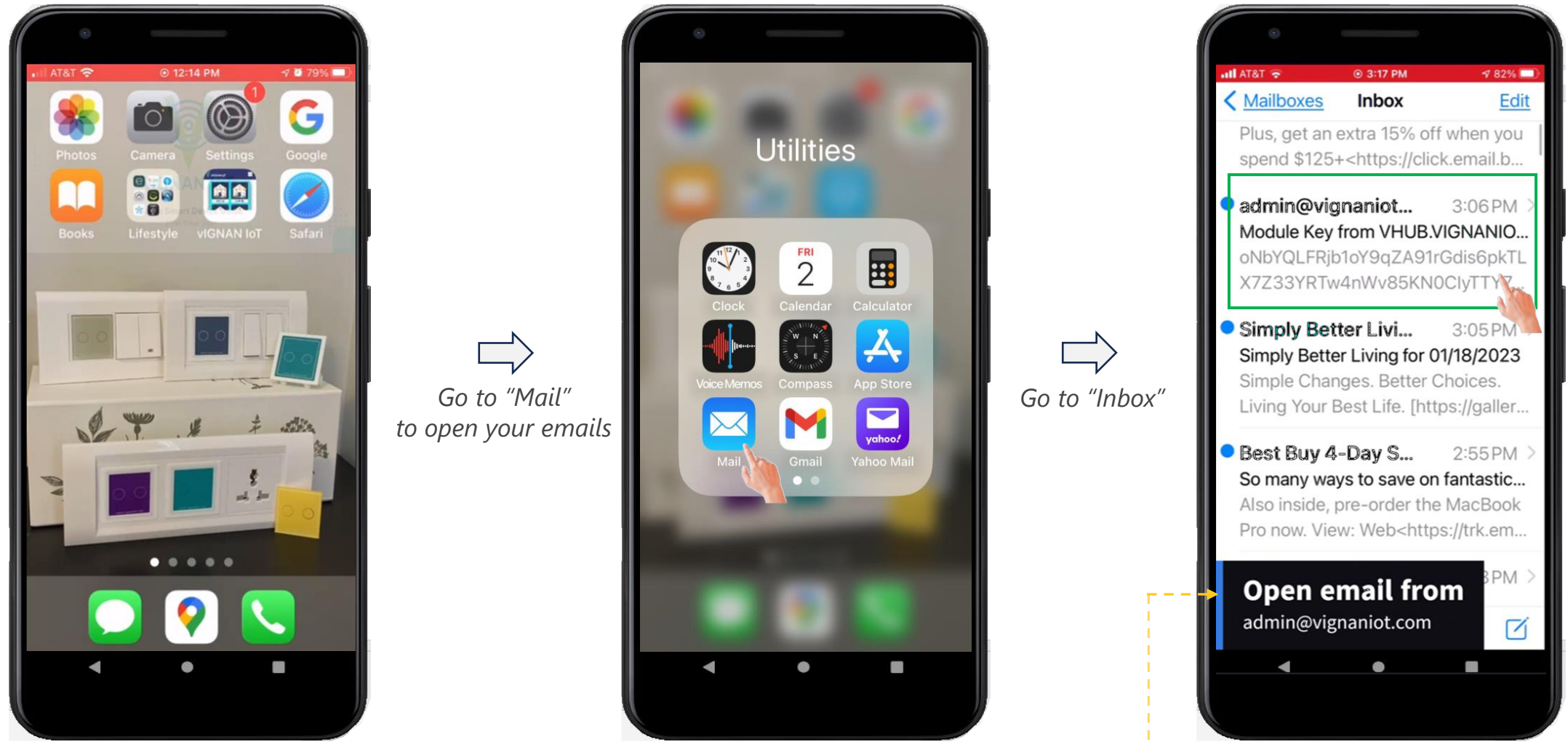

## Setup vIGNAN IoT's Smart Device User Guide

1. On your smart phone, go to "Mail" and open your email Inbox\*. Open email from [admin@vignaniot.com](mailto:admin@vignaniot.com) that has a module key.  
**Note:** At this stage it is assumed that the smart device you are setting up is already electrically powered "ON" and wired with loads.



\* If you are receiving email from vIGNAN IoT for the first time then you may want to check your Junk Box for an email from [admin@vignaniot.com](mailto:admin@vignaniot.com)". Move this email to your Inbox to open.

You will **not** see this message on your phone. This is an instruction message to guide the user.

- Highlight and copy the module key. This module key will be required during the device setup.

**Note:** You will receive a module key only after adding a device in "vHUB Device Manager" app.

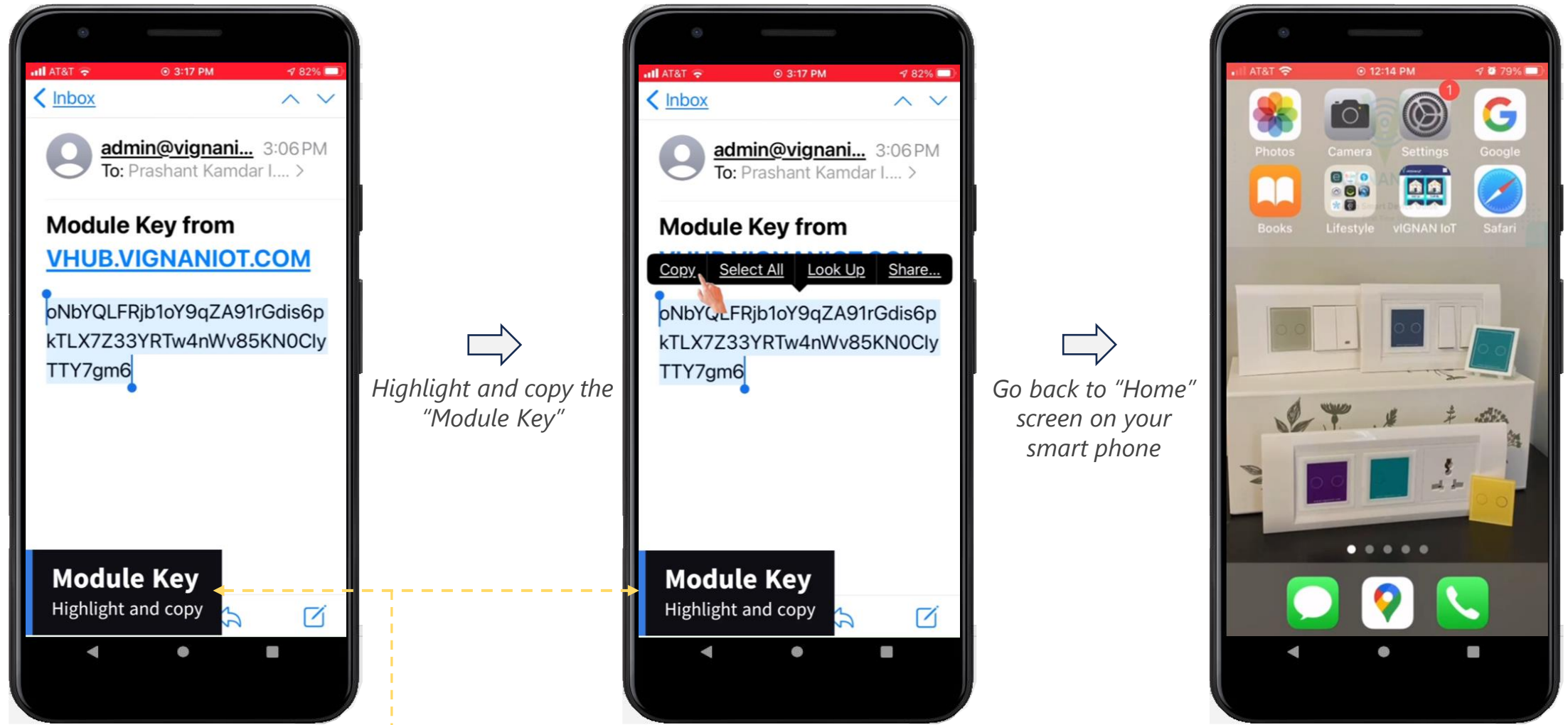

You will **not** see these messages on your phone. These are instruction messages to guide the user.

3. Go to "Settings" and to "WiFi".

**Note:** At this stage it is assumed that the smart device you are setting up is already electrically powered "ON" and wired with loads.

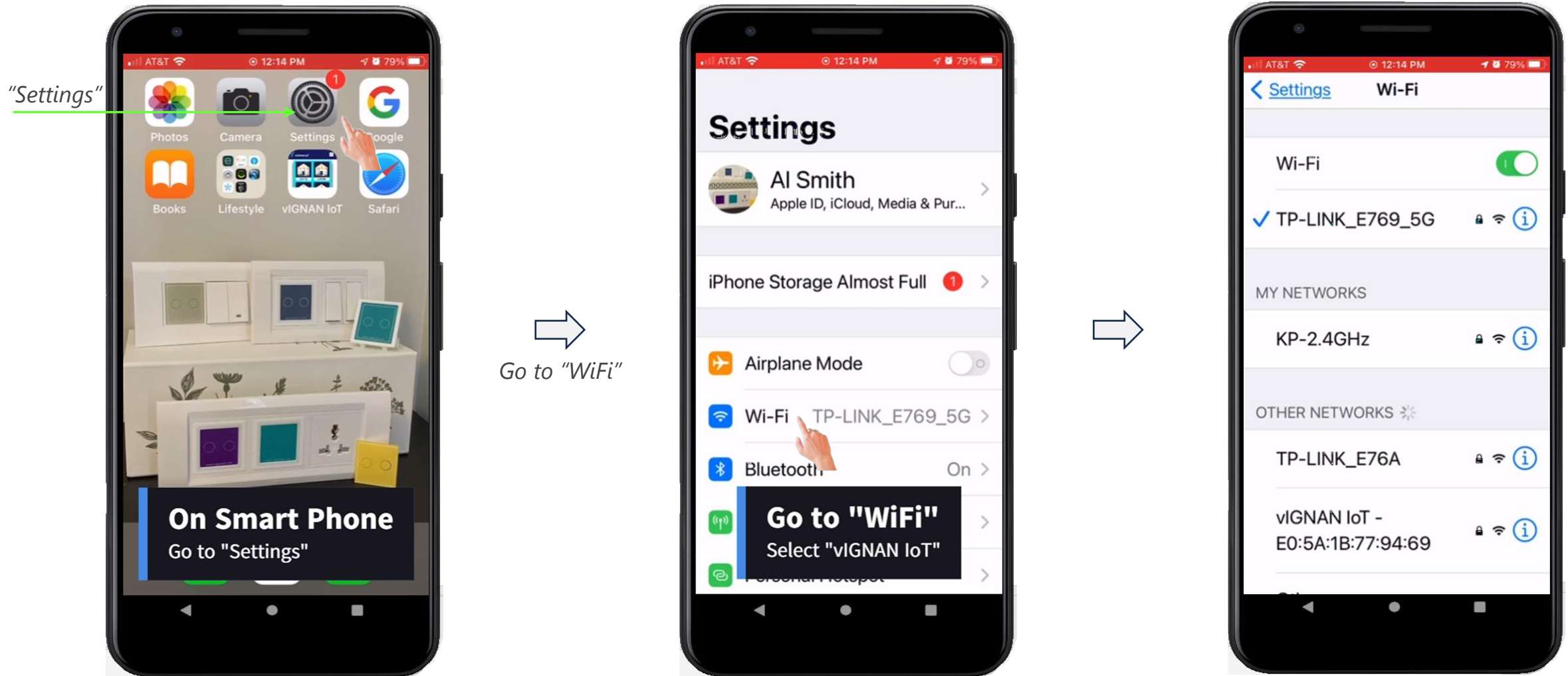

4. Under "WiFi" scroll down and select WiFi network name "vIGNAN IoT - xx:xx:xx:xx:xx:xx". Type the password provided in the device package and click on "Join".

**Note:** This is the step where you connect to vIGNAN IoT device's WiFi network.

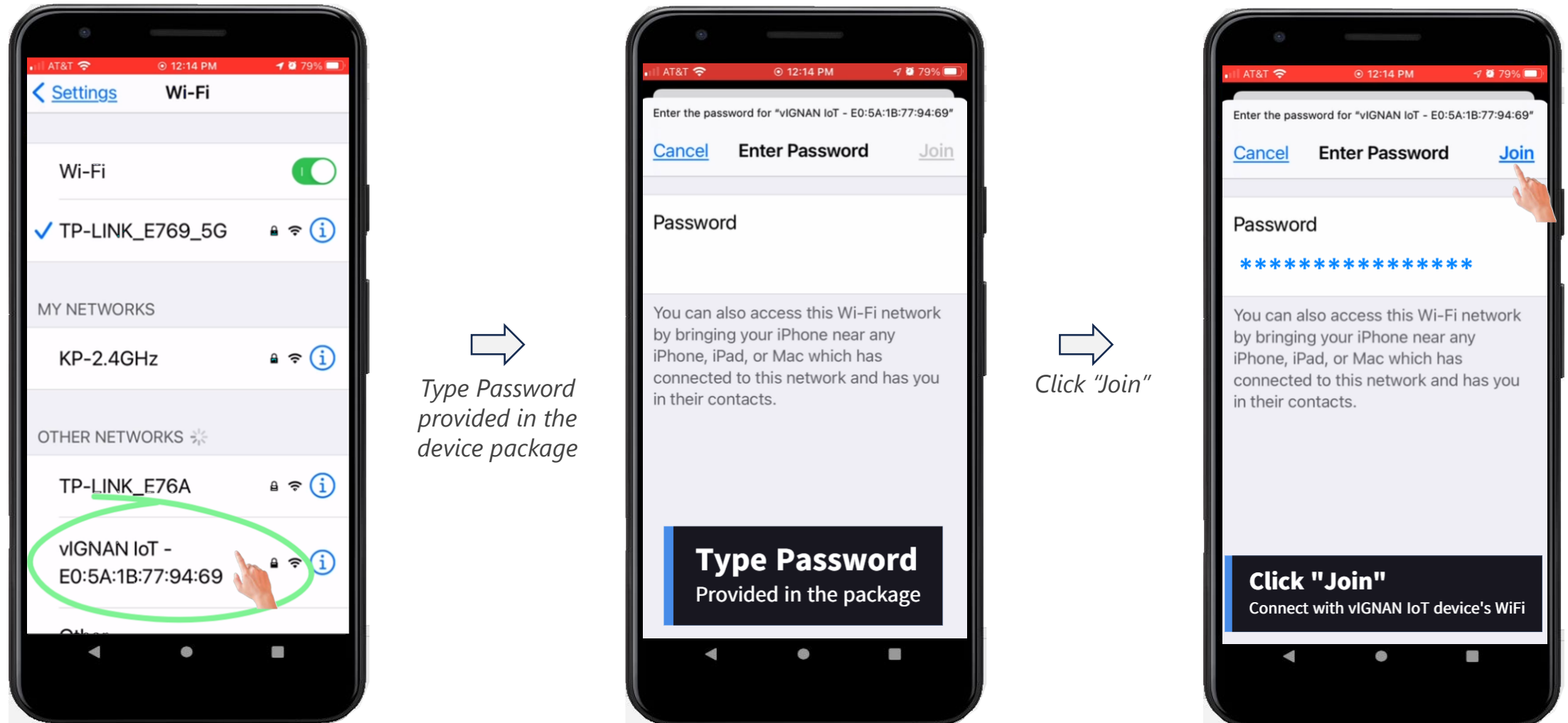



5. Connecting to vIGNAN IoT device's WiFi network takes 1-2 minutes.

➡  
*Connecting.....*

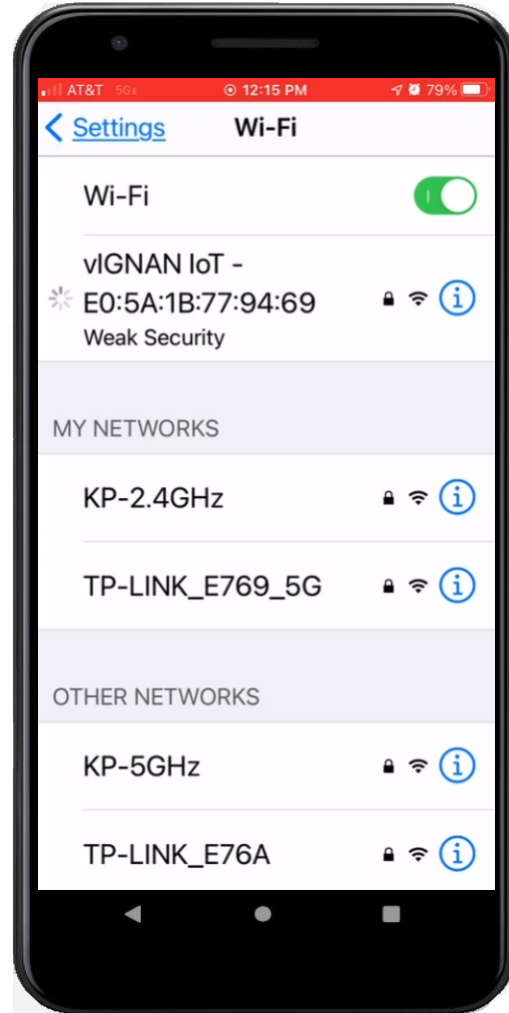

➡  
*Connected*

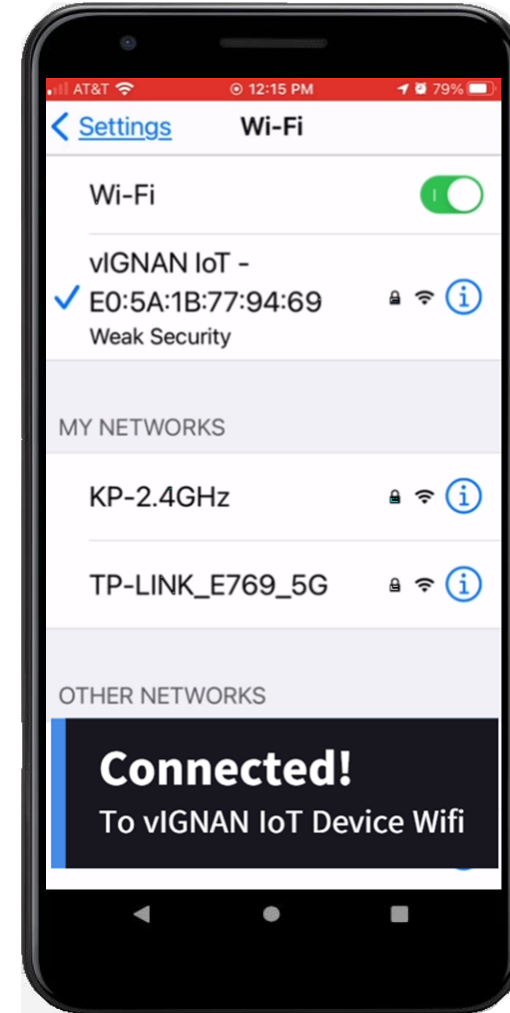

6. Open Internet Browser on your smart phone, type the IP address "192.168.4.1" and click on "go" button.  
*This will launch the vIGNAN IoT Smart Device "Login" page. Type the user id "admin" and password "admin" to login.*

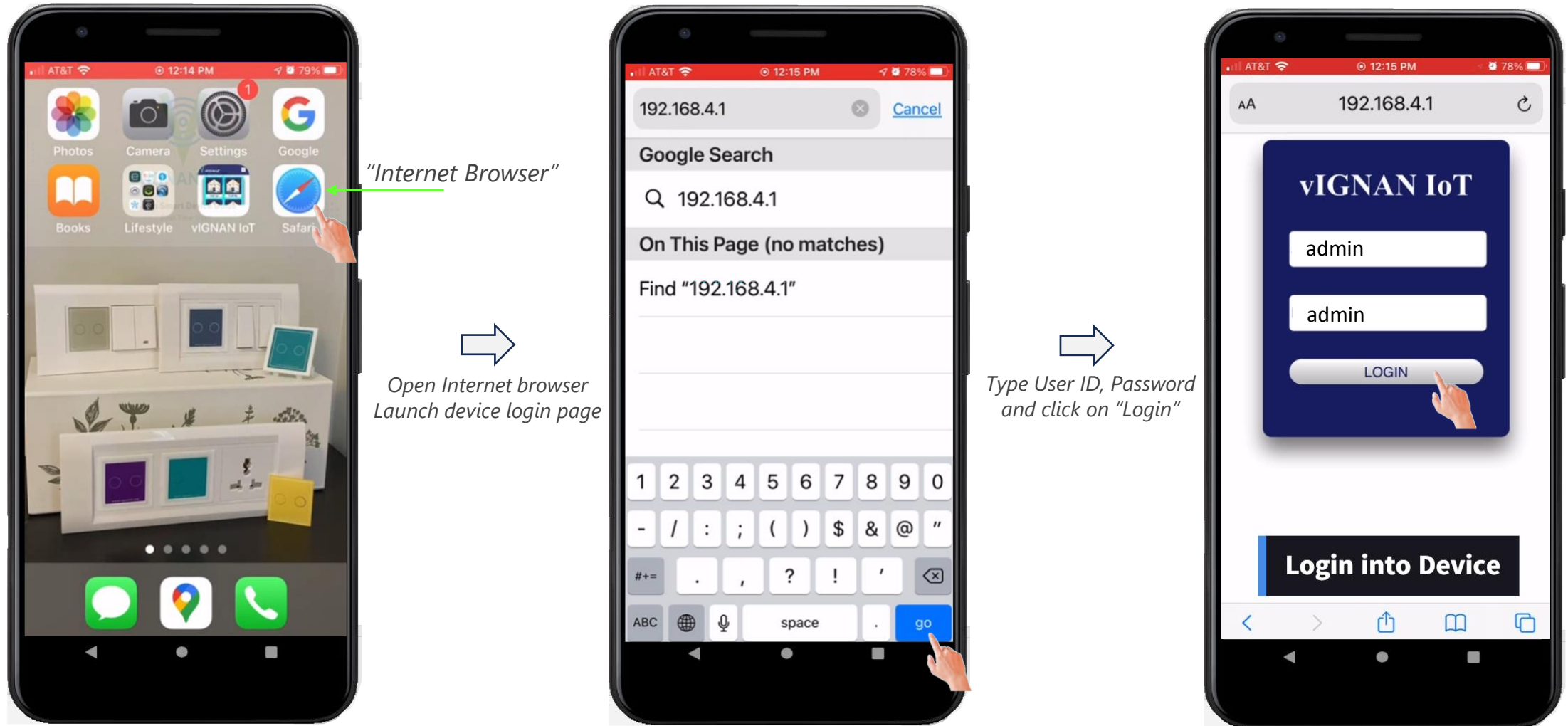

7. On successful login, you will see "Step-1" to "Submit Module Key". Click on the blank box and paste the "Module Key" that you had copied from your email at the beginning of this instruction guide.



*Click on the blank box*

➡  
*Paste the "Module Key"*

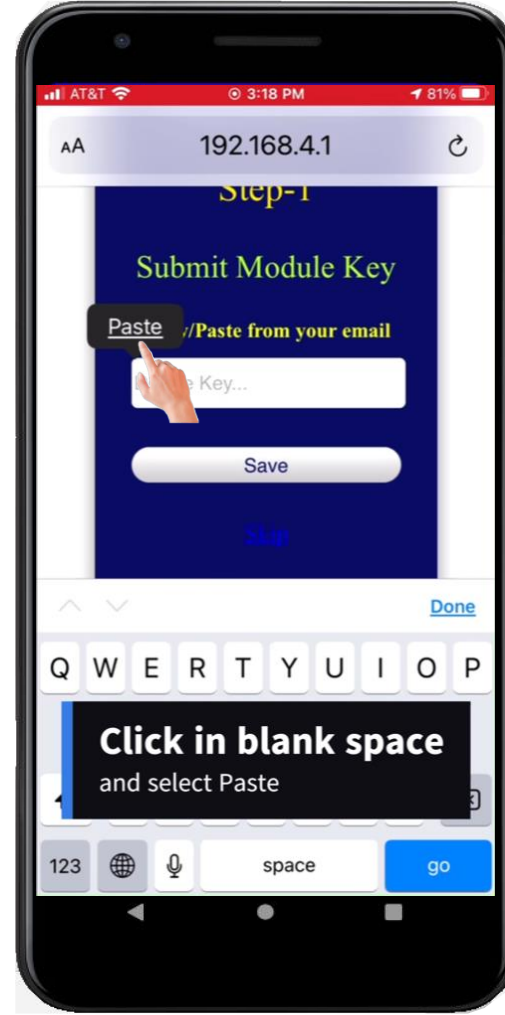

➡  
*"Module Key" pasted*

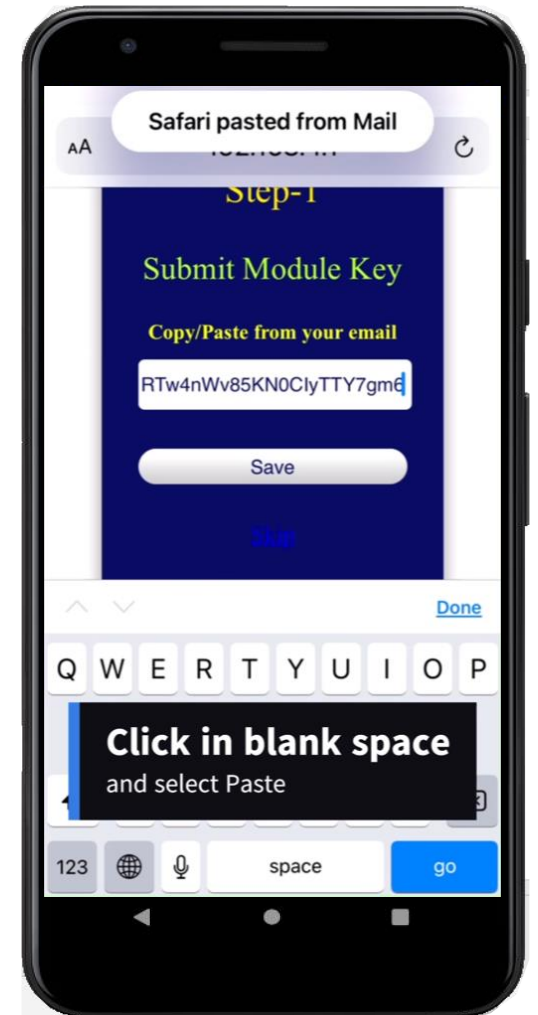



8. Click on "Save" button which will begin the writing of "Module Key" into the vIGNAN IoT Smart Device.  
*Saving/writing of module key to the device takes 1 minute.*

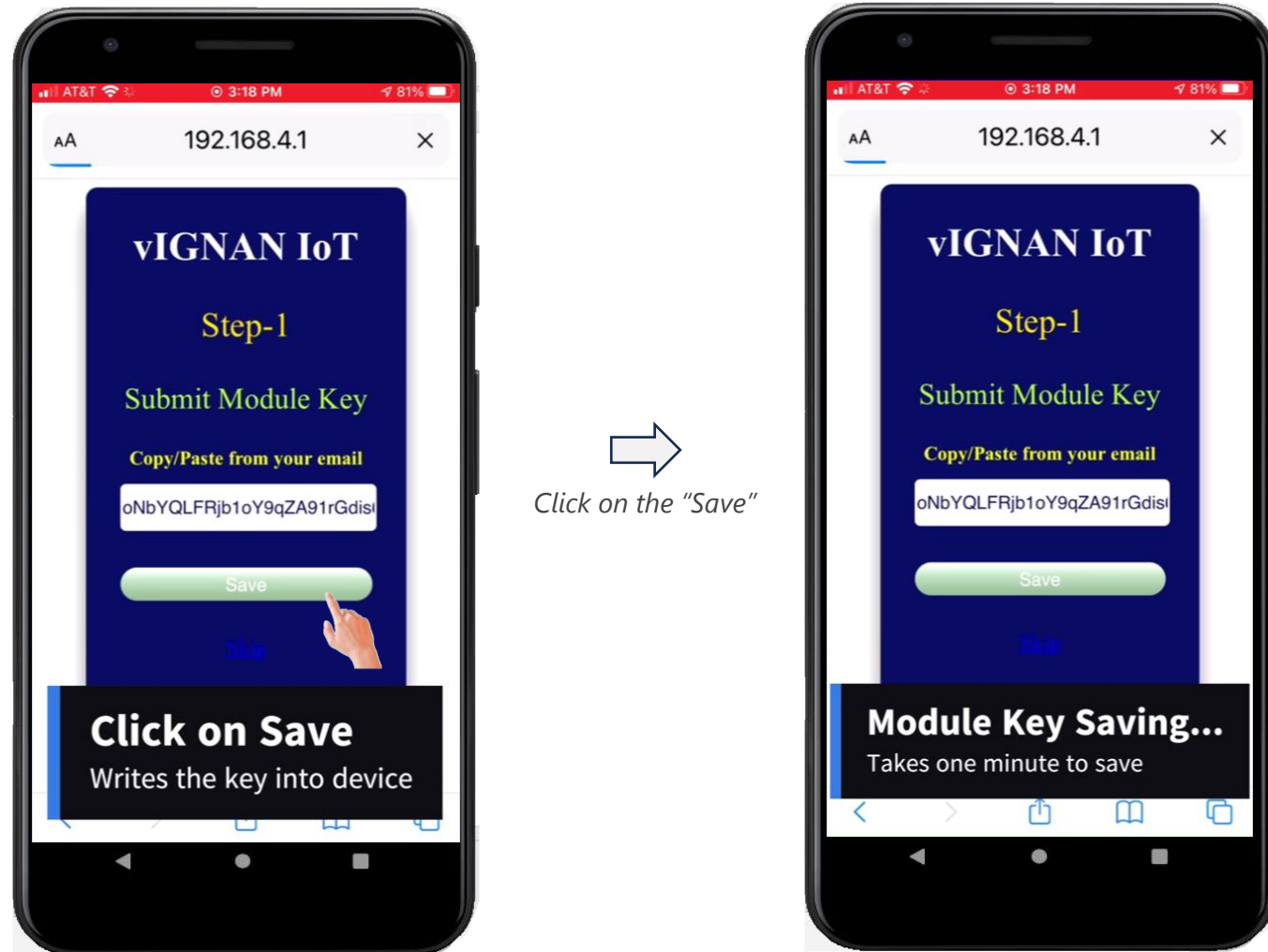

9. On successful saving of the "Module Key", you will go to "Step-2" and "Select Time Zone". In the drop down, select your time zone and click on the save button.



*Click on the "Drop Down"*

→  
*Scroll to your time zone  
and click "Done"*

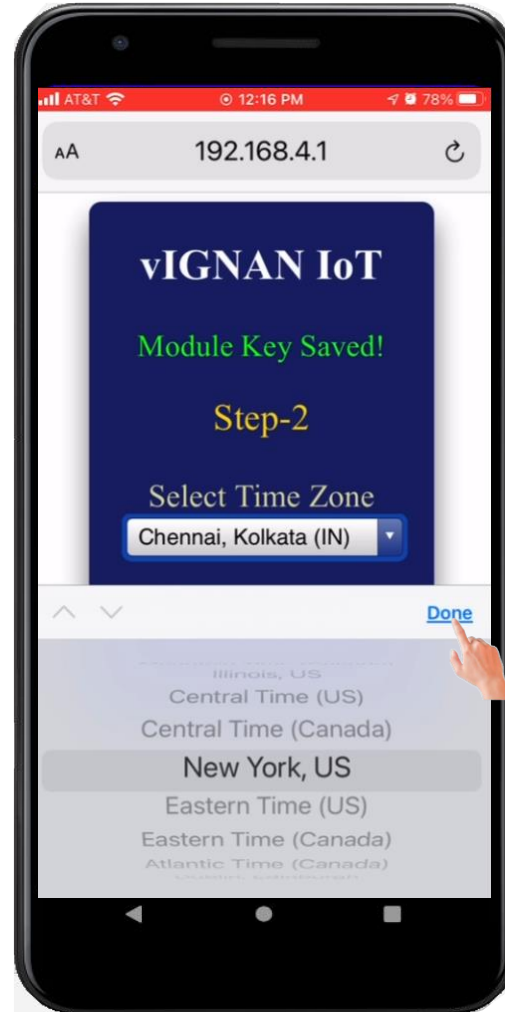

→  
*Click on the  
save button*



9. On successful saving of the "Time Zone", you will go to the **final step** "Step-3" and click on "Scan WiFi Networks". This will list all the WiFi networks that vIGNAN IoT Smart Device can access. Select your home WiFi network from the list by clicking on it.
10. Next, type your home WiFi network password and click on the save button.



*Click on the "Scan WiFi Networks"*

→  
*Select and click on  
your home WiFi network*

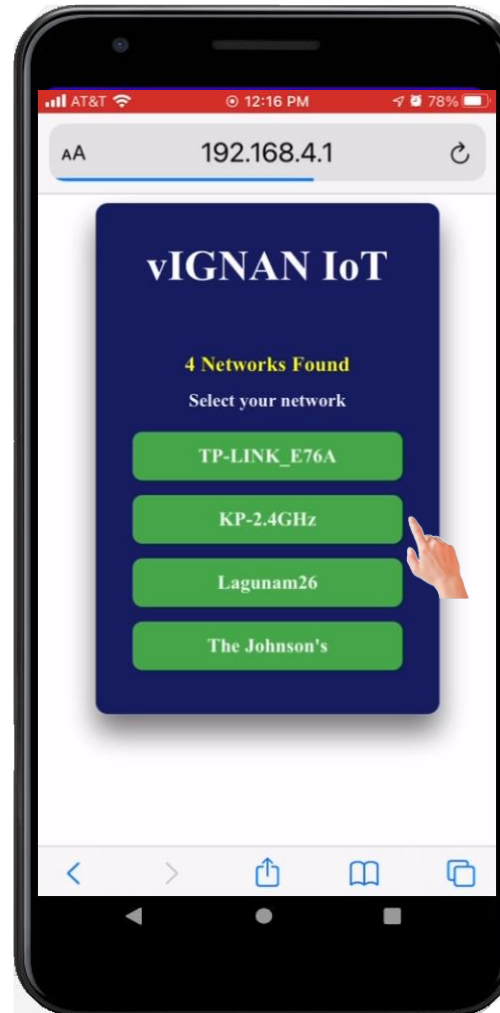

→  
*Type your home WiFi  
network password and  
click on the save button*

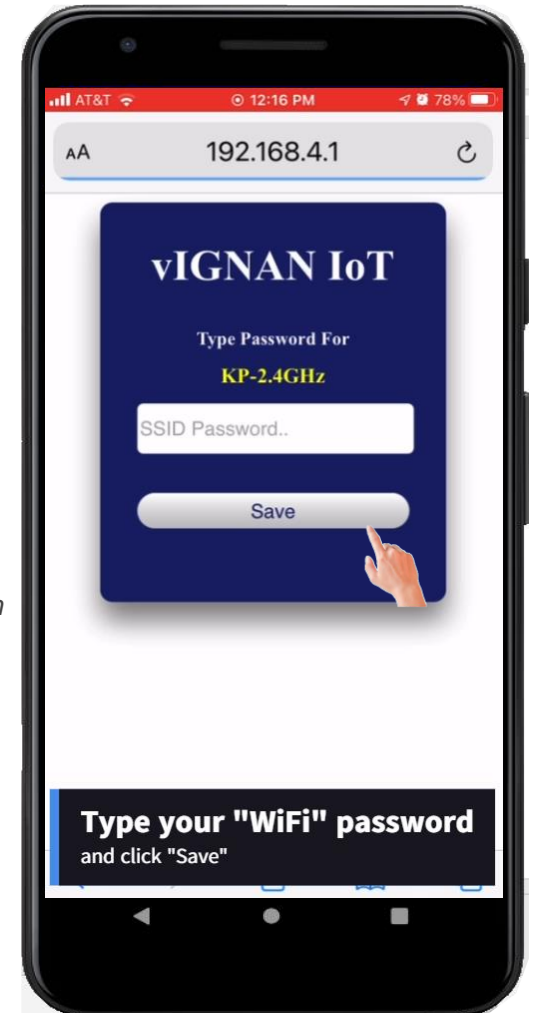

11. On successful connection with your selected home WiFi network, your device will display a “**Congratulations!**” message and reboot.

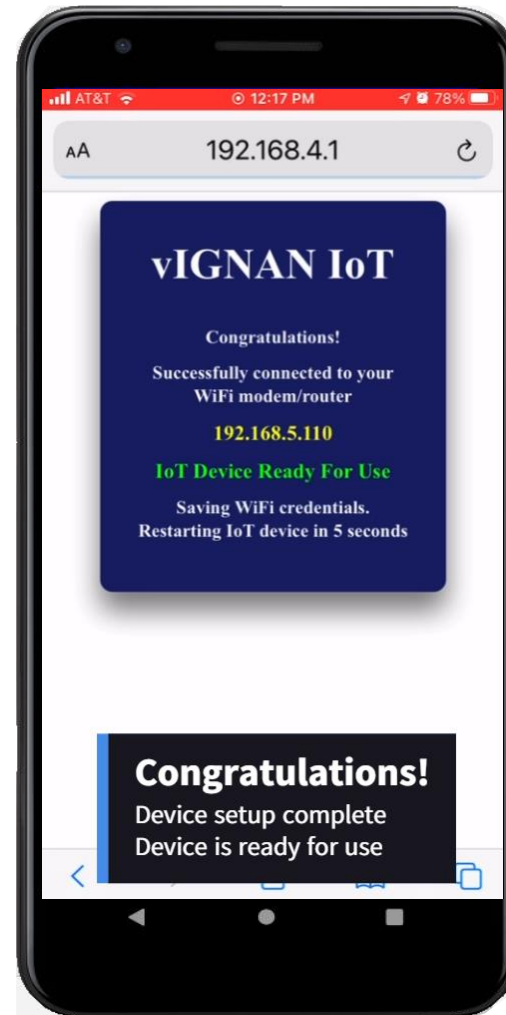



## Testing vIGNAN IoT's Smart Device from vHUB Device Manager App





1. Open Internet Browser on your smart phone and go to "vignaniot.com" home page. Click on the accordion drop-drop down menu and click on "Login" button.



*"Internet Browser"*



*Open Internet browser  
Type "vignaniot.com"  
and click on "go"*

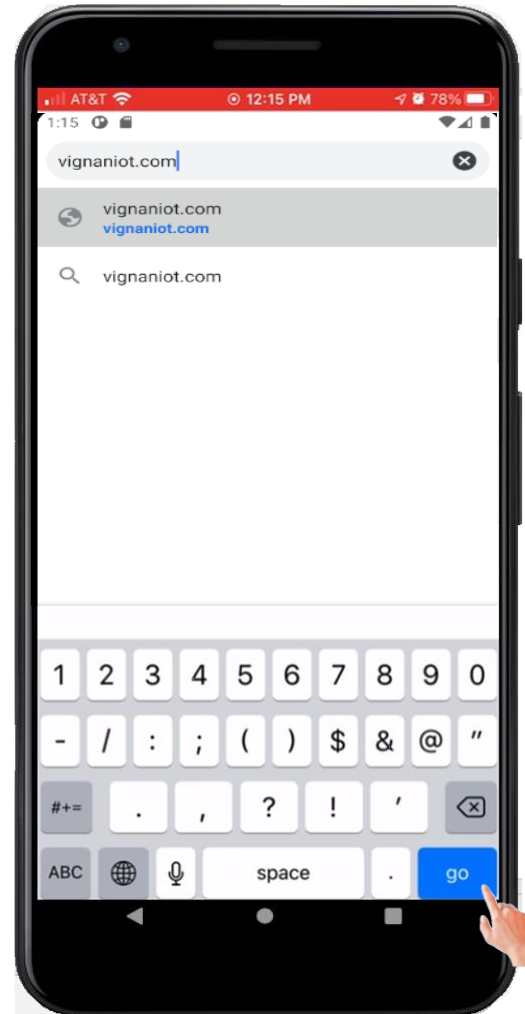

*This will launch "vIGNAN IoT"  
home page.  
Click on the accordion  
drop-down menu*

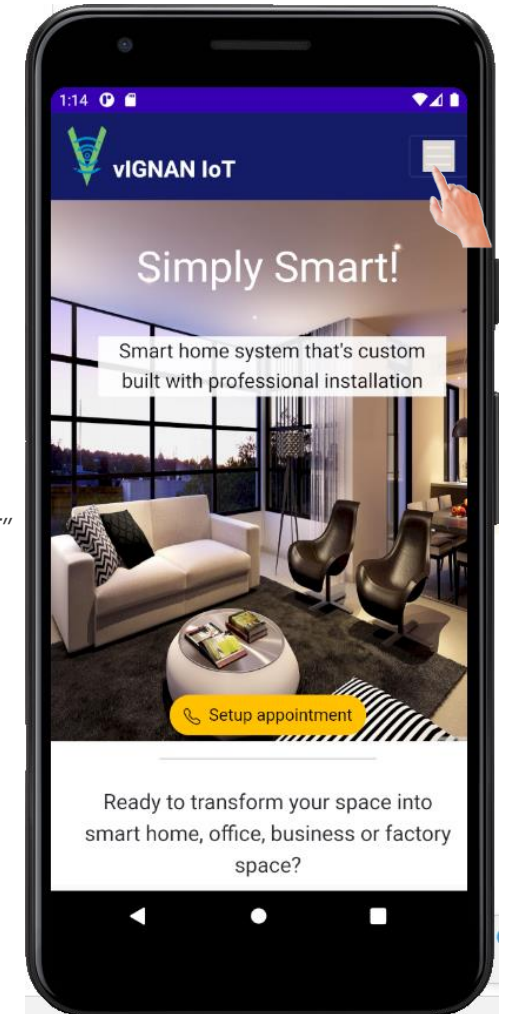

2. Click on the "Login". This will launch "vHUB Device Manager" app login screen. Type in the login credentials and click on login. On successful login, first screen you will see is a list of "Homes". In our example there is only one home created and it is "Atlanta"
3. Click on the "Atlanta" home. This will list all the rooms created in "Atlanta" home. In our example there is only one room created and it is "Livingroom".

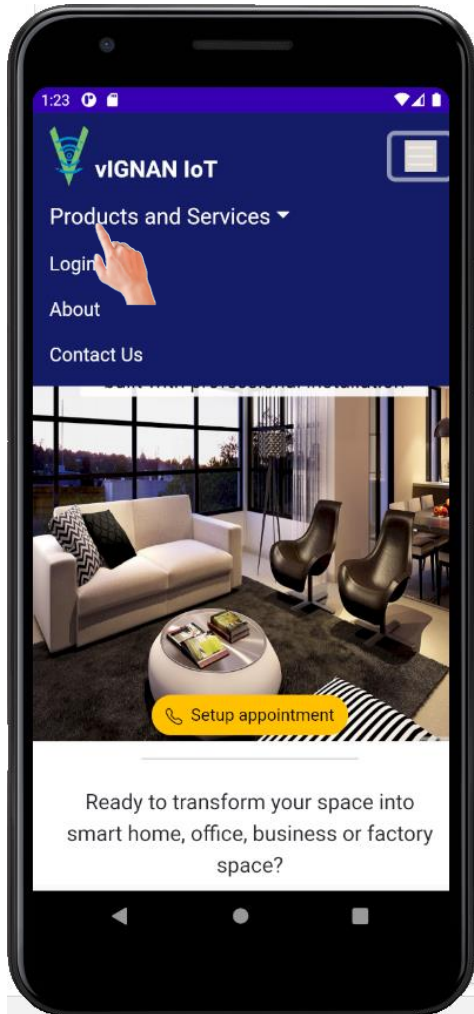

Click on "Login"

➡  
Type in the login credentials  
and click on "Login" button

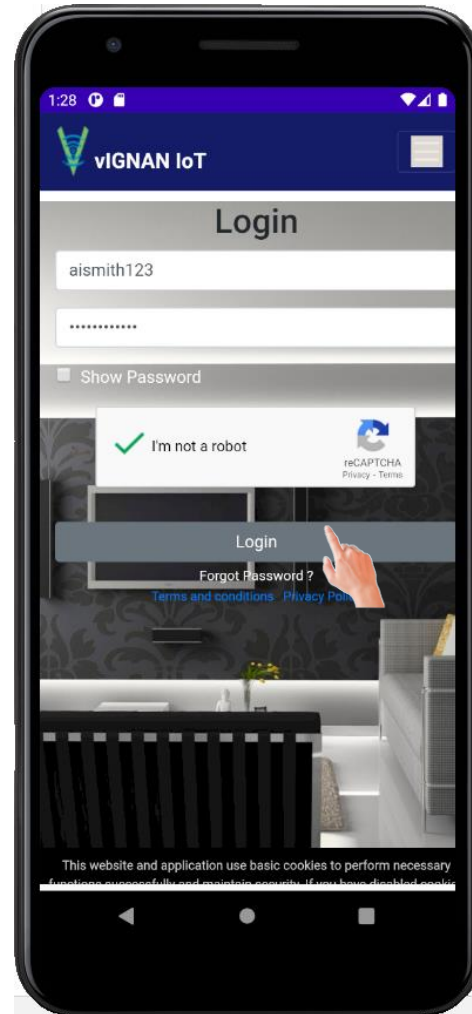

➡  
List of "Homes" are  
displayed

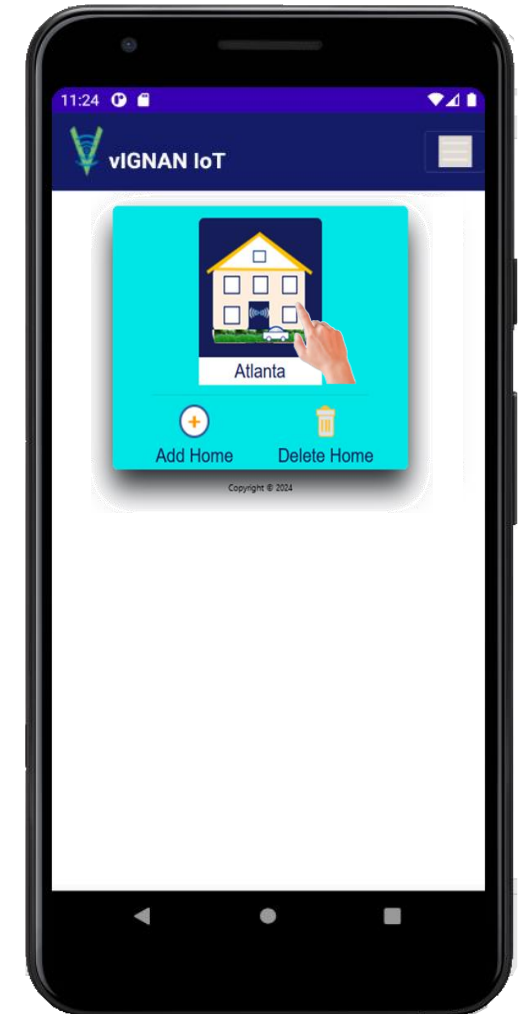

3. Click on the room "Livingroom" to list all the devices in this room.  
Click on the "OFF" button for any of the appliance/fixture and verify that it turns "ON". Click back on the "ON" button and verify that the appliance/fixture turned off.

*If this worked then you successfully completed the setup and configuration of the "vIGNAN IoT's Smart Device" and "vHUB Device Manager App".*

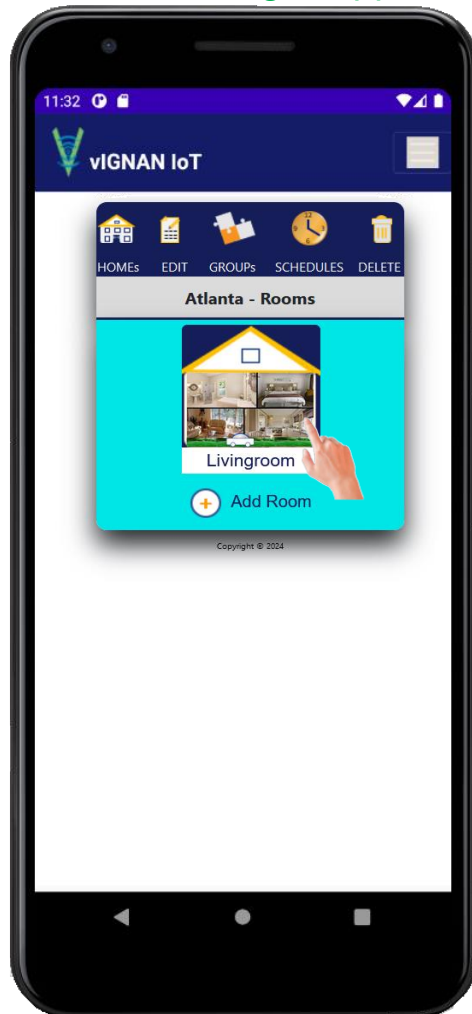

Click on the room "Livingroom"

Click on the "Livingroom" to list all the devices in this room. Next, click on "OFF" button to turn the fan "ON"

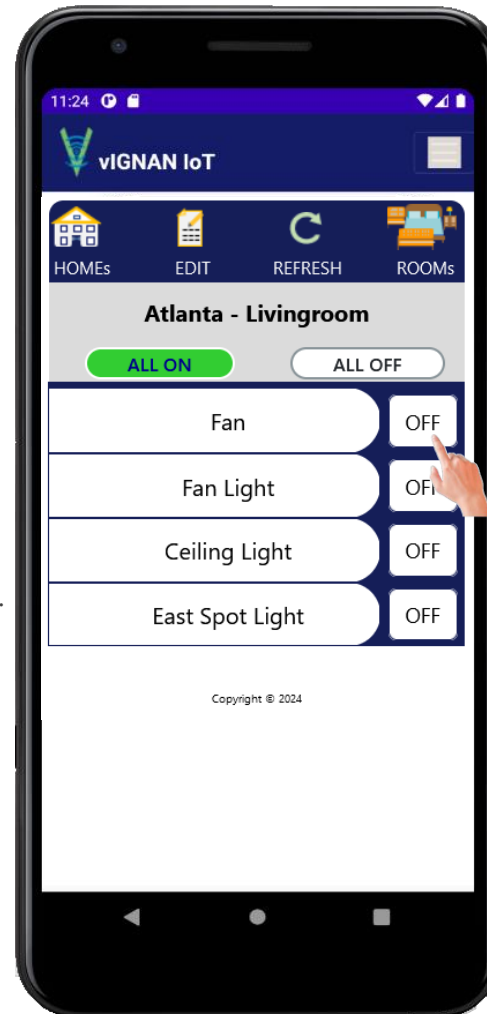

www.vignaniot.com  
© 2024 vignaniot.com

Click back on the "ON" button to turn it "OFF"

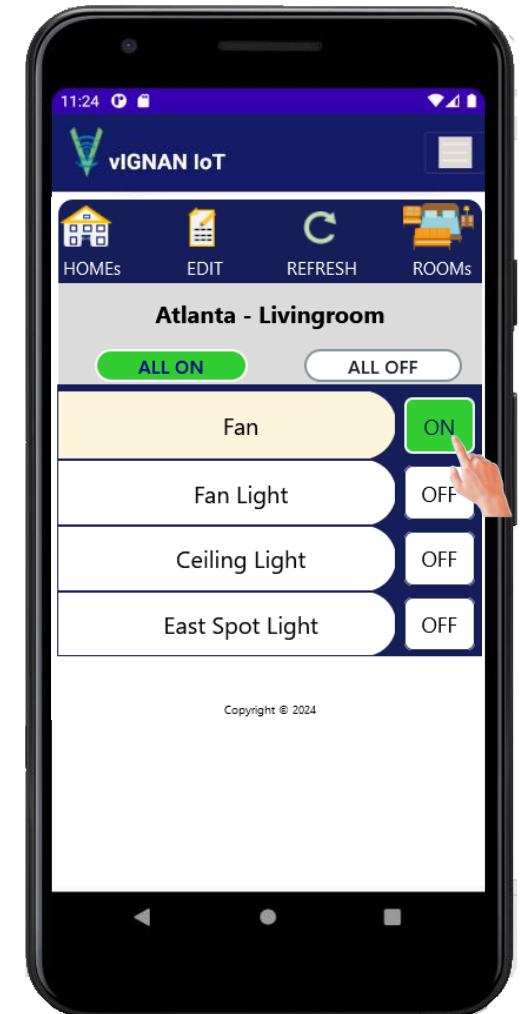

## ***Congratulations!***

You successfully completed the setup and configuration of the "vIGNAN IoT's Smart Device" and "vHUB Device Manager App"

***Tutorial links to follow for setting up more features, check the link below:***

- User guides for "Existing Users"  
<https://www.vignaniot.com/support.html>